

TURNTABLE

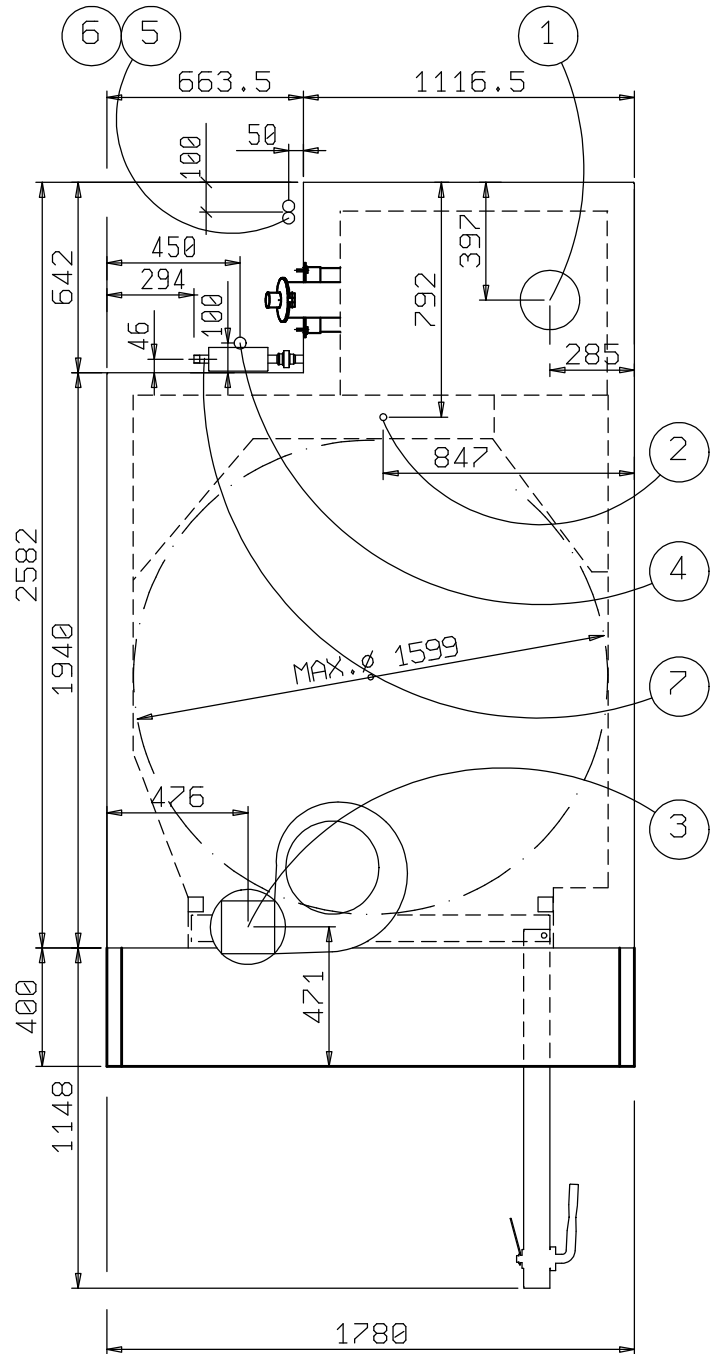

8		
8		
7	WATER DISCHARGE	Ø 3/4"
6	BURNER SUPPLY OIL	Ø 1/4"
5	BURNER SUPPLY GAS	Ø 1" 1/4"
4	ELECTRIC ENERGY ARRIVAL	KW 3
3	STEAM EXHAUST PIPE	Ø200
2	STEAM GENERATOR WATER ARRIVAL	Ø 1/2"
1	SMOKE EXHAUST PIPE	Ø200
<b>POS.</b>	<b>DENOMINATION</b>	

WEIGHT Kg. 1800  
NOZZLE OIL GPH 2,75 A 60°  
NEEDED KCAL OVEN KCAL120.000

**TECHNICAL FEACTURES**  
**ROTORFAN 9 80x120 FN92**

BOLL.

DATA

UISTO

21.03.03

DIS.

DIS. N°

POS. 390



DISEGNO DI PROPRIETA' RISERVATA E NON PUO' ESSERE RIPRODOTTO O MOSTRATO A TERZI AI SENSI DI LEGGE

MINIMUM PASSAGE FOR DISSEMBLED OVEN 905x1780